



1300 ENTERPRISE ROAD GENEVA, ALABAMA 36340-0580 800-239-4621 FAX 1-800-508-1469 www.reliablelouvers.com

## RCS STATIONARY LOUVERS ROUND AND SEMIROUND SHAPES EXTRUDED ALUMINUM

### STANDARD CONSTRUCTION

**FRAME**

6063T5 extruded aluminum. RCS louvers are constructed with the standard or flange frames shown on this page. Drainable head and jamb frames are not utilized.

**BLADES**

6063T5 extruded aluminum.

**SCREEN**

<sup>3</sup>/<sub>4</sub>" x .051" (19 x 1.3) expanded, flattened aluminum bird screen. Screen adds approximately <sup>1</sup>/<sub>2</sub>" (13) to louver depth.

**FINISH**

Mill.

**MINIMUM SIZE**

RCS245D – 18" (457) diameter.  
All others – 24" (610) diameter. Consult Reliable if smaller sizes are required.

**MAXIMUM SIZE.**

Typically shall be 75 ft<sup>2</sup> (7m<sup>2</sup>) per section, not to exceed 120"w x 90"h (3048 x 2286) or 90"w x 120"h (2286 x 3048). Consult Reliable for section information on specific size louvers.

Louvers larger than the maximum factory assembly size will require field assembly of smaller sections.

**SUPPORTS**

Louvers may be provided with rear mounted hidden vertical blade supports (HVBS) that increase louver depth (see detail). Support depth varies depending on louver size, assembly configuration or windload.

**PERFORMANCE**

The drainable styles offered in RCS louvers are only performance tested in a square louver configuration. RCS louver performance may differ from comparably sized RCS models. RCS models are not licensed to bear the AMCA Seal for performance.

**\*See individual louver model spec sheet for more detailed construction information.**

### FEATURES

The RCS offers:

- Architecturally styled, hidden mullions for attractive appearance.
- Corrosion resistant, all aluminum construction.
- Outstanding durability and low maintenance.

### VARIATIONS

Variations to the basic design of this louver are available at additional cost. They include:

- Extended sill.
- Flange frame.
- Hinged frame.
- Front or rear security bars.
- Filter racks.
- A variety of bird and insect screens.
- Selection of finishes: prime coat, baked enamel (modified fluoropolymer), Pearledize 50 & 70, Kynar, clear and color anodize (some variation in anodize color consistency is possible).

Consult Reliable for other special requirements.

### SUPPORT DETAIL

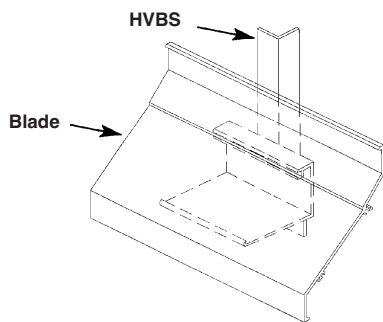

### BLADE STYLE OPTIONS

230RB	645RB
245RB	6375Z
245D	6375Z125
4375Z	445RB
4375D	2DDWRG
445RD	4DDWRG
445RD125	5DDWRG
4RCH-V	3RRGH
445DD	4RRV
4375B	6RRSV
6350DS	

### FRAME CONSTRUCTION

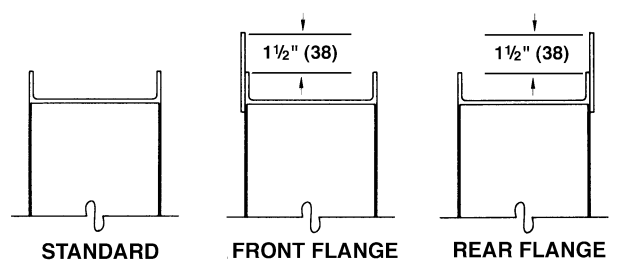

Dimensions in parenthesis ( ) indicate millimeters.

\*Unit is furnished <sup>1</sup>/<sub>4</sub>" (6) smaller than given opening dimensions.

QTY.	BLADE STYLE	SHAPE					SIZE				FRAME	VARIATIONS
		A	B	C	D	E	A*	B*	C*	D*		
<b>JOB</b>						<b>LOCATION</b>						
<b>CONTRACTOR</b>												

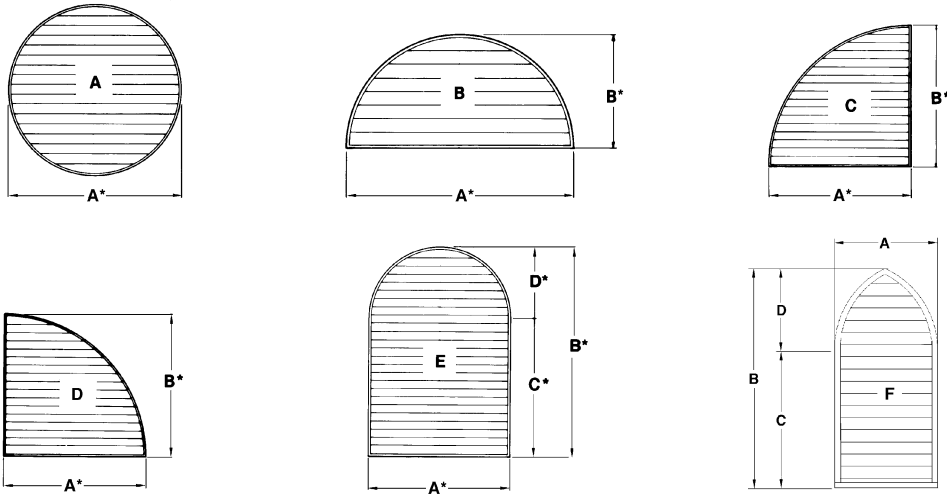
**STANDARD SHAPES FRONT VIEWS**

\*Units furnished 1/4" (6) smaller than given opening dimensions.

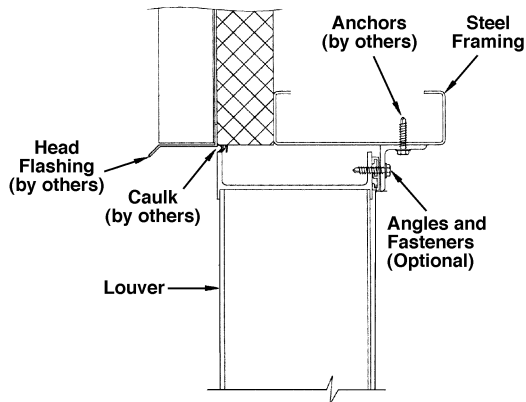
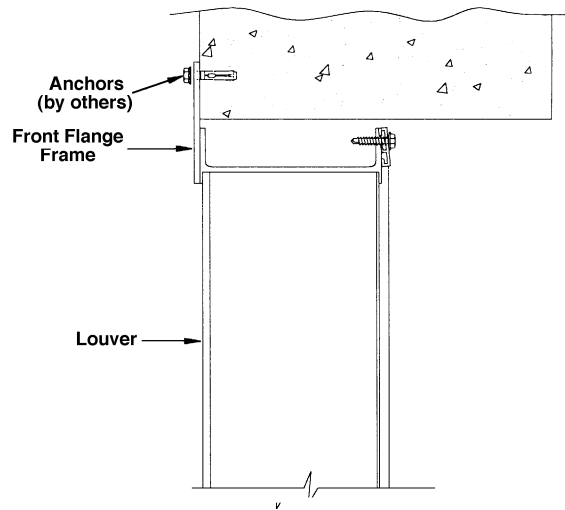
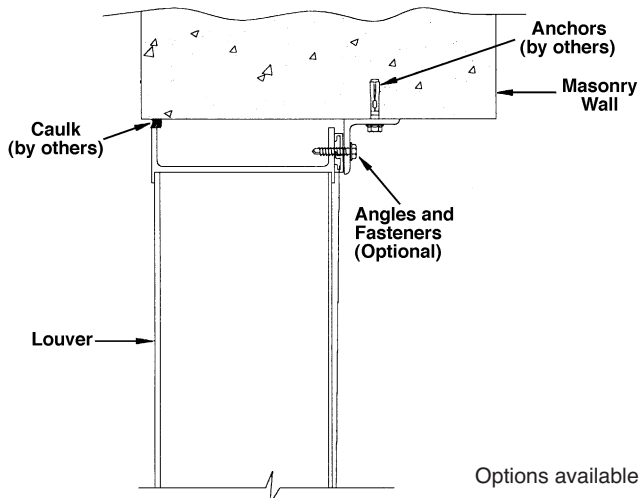
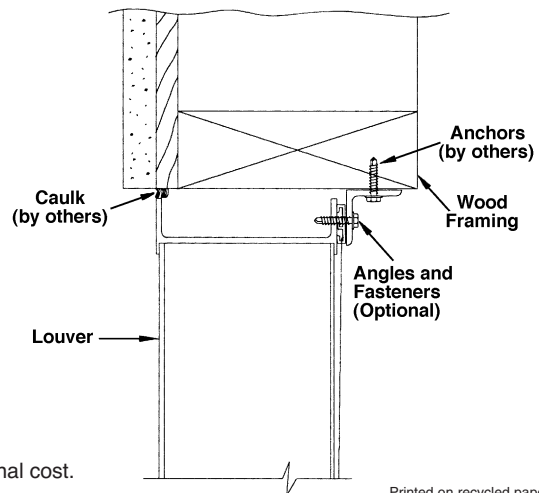
**TYPICAL INSTALLATION DETAILS****Metal Panel Wall****Flange Mount****Masonry Wall****Wood Installation**

Options available at additional cost.